

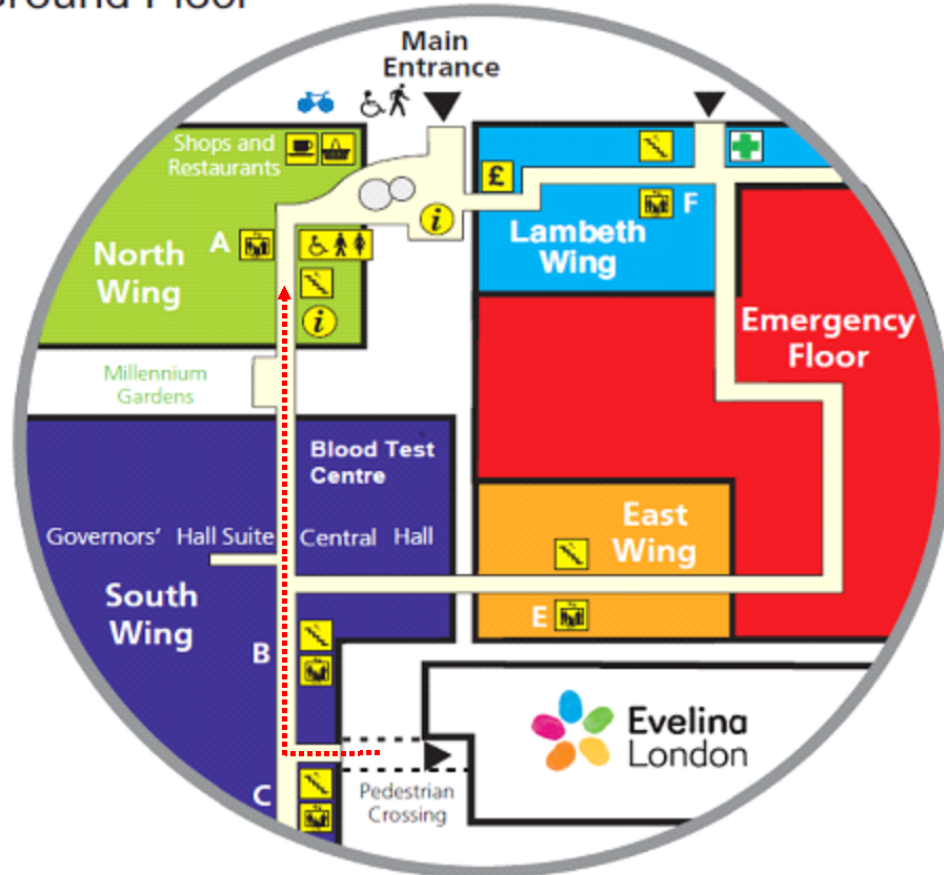

Evelina London to North Wing 10th Floor

Directions: If you are leaving from the Evelina, go into St Thomas' using the entrance directly opposite you, turn right at the end of the short corridor and make your way to the North Wing (green zone). Lifts A are just before you get to WHSmith, take one to the 10th Floor. Depending on which side of the lift lobby you get out, turn left or right to go towards the Children's Day Unit, William Gull and Hand and Plastics Emergency. The entrance to Children's Day Unit is in the top right hand corner past Hand and Plastics Emergency.

Ground Floor



10th Floor North Wing

