

What is pre-assessment and why is it important?

This leaflet explains what pre-assessment is and why it is important for your child to have a pre-assessment before their operation, procedure or planned test.

What is a Pre-assessment Clinic?

If your child needs to have an operation, or any planned test involving a general anaesthetic, you will be asked to attend a Pre-assessment Clinic.

Why is it important that your child attends?

At the Pre-assessment Clinic we make sure your child is well enough to have a general anaesthetic.

If your child has not had a pre-assessment check before the date of their operation, planned test or procedure, your child's admission may have to be delayed until a pre-assessment has been done.

What happens during the appointment?

A specialist nurse or nursing assistant will check your child's medical history, take their blood pressure, pulse, temperature and oxygen levels as well as measure their height and weight. They will also take swabs; this is routine and checks for any infections that might affect your child's operation, planned test or procedure.

Your child may need additional tests. These tests may include:

- blood tests
- ECG (electrocardiogram – measures the electrical activity of the heart)
- x-rays

If your child needs any of these tests and it isn't possible to do them on the day of your pre-assessment, we will arrange for them to be done before your child's stay in hospital.

You might find it useful to watch our specially-created films with your child, **Pre-assessment** and **The Day of the Operation**. These films will help your child understand what will happen when they come to hospital.

To access them please search for 'pre-assessment' on the Evelina London website, or follow this link:

<http://www.evelinalondon.nhs.uk/our-services/hospital/Operations/pre-assessment.aspx>

Where is the Pre-assessment Clinic?

The Pre-assessment Clinic can be found on the Ground Floor, South Wing in St Thomas' hospital (next to Shephard's Hall restaurant).

Children's Pre-assessment St Thomas' Hospital South Wing - Ground Floor

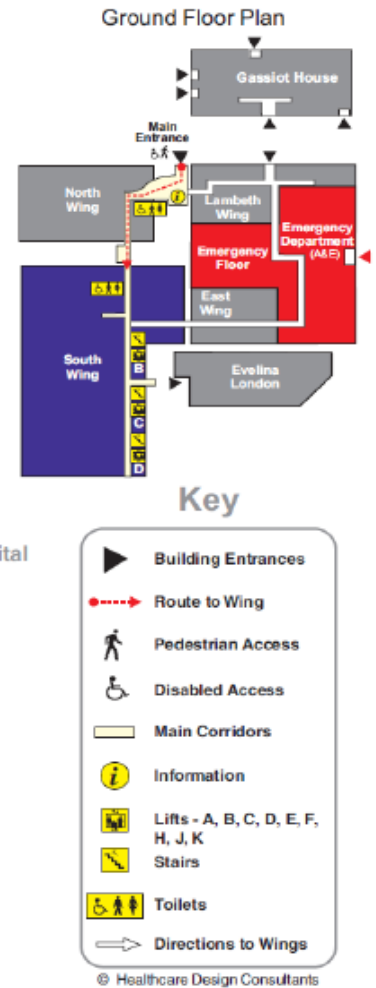
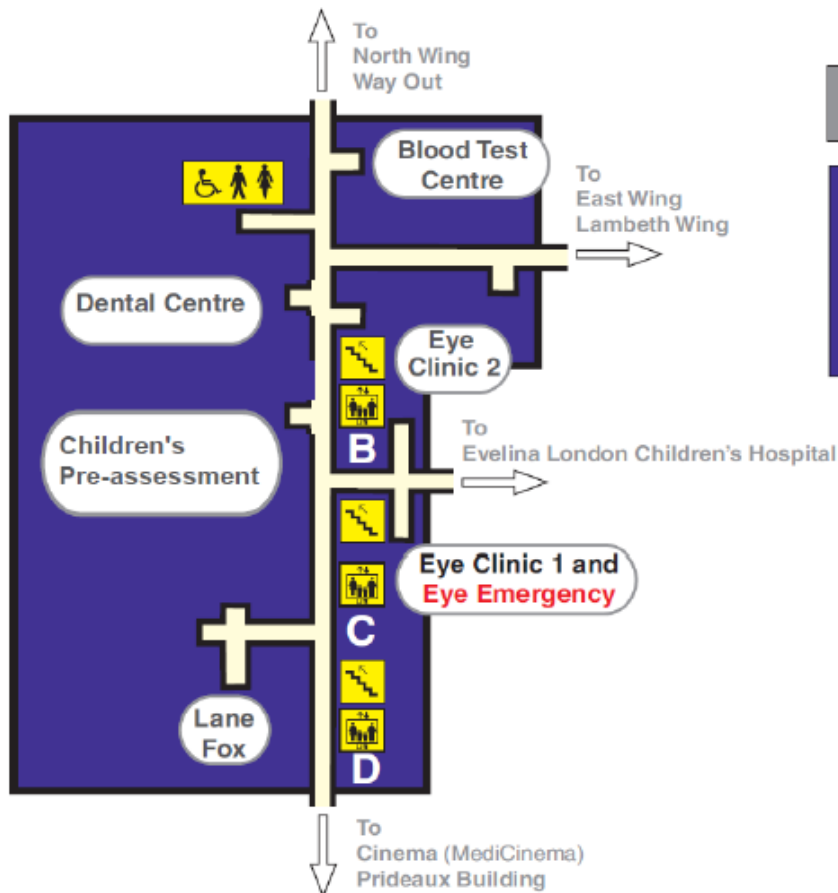

Contact us

If you have any questions or concerns about your appointment, please contact the Pre-assessment Clinic, **t:** 020 7188 7188 extension 56222, 56223 or 56224, Monday to Friday, 9am to 5pm.

For more information leaflets on conditions, procedures, treatments and services offered at our hospitals, please visit www.evelinalondon.nhs.uk/leaflets

Evelina London Medicines Helpline

If you have any questions or concerns about your child's medicines, please speak to the staff caring for them or contact our helpline.

t: 020 7188 3003 10am to 5pm, Monday to Friday **e:** letstalkmedicines@gstt.nhs.uk

Your comments and concerns

For advice, support or to raise a concern, contact our Patient Advice and Liaison Service (PALS). To make a complaint, contact the complaints department.

t: 020 7188 8801 (PALS) **e:** pals@gstt.nhs.uk

t: 020 7188 3514 (complaints) **e:** complaints2@gstt.nhs.uk

Language and accessible support services

If you need an interpreter or information about your care in a different language or format, please get in touch.

t: 020 7188 8815 **e:** languagesupport@gstt.nhs.uk

NHS 111

Offers medical help and advice from fully trained advisers supported by experienced nurses and paramedics. Available over the phone 24 hours a day.

t: 111

NHS Choices

Provides online information and guidance on all aspects of health and healthcare, to help you make choices about your health.

w: www.nhs.uk

Get involved and have your say: become a member of the Trust

Members of Guy's and St Thomas' NHS Foundation Trust contribute to the organisation on a voluntary basis. We count on them for feedback, local knowledge and support. Membership is free and it is up to you how much you get involved. To find out more, please get in touch.

t: 0800 731 0319 **e:** members@gstt.nhs.uk **w:** www.guysandstthomas.nhs.uk/membership

Leaflet number: 4536/VER1

Date published: January 2018

Review date: January 2021

© 2018 Guy's and St Thomas' NHS Foundation Trust
A list of sources is available on request